

36X24 DECK PANEL

***ALL DIMENSIONS ON THIS PAGE ARE NOMINAL**

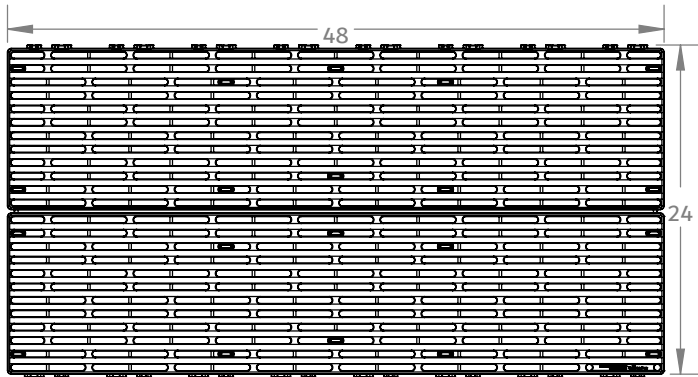

DOCUMENT:
SNAP DECKING PANEL
DIMENSIONS - FINAL
TITLE:
PRODUCT OVERVIEW



48X24 DECK PANEL

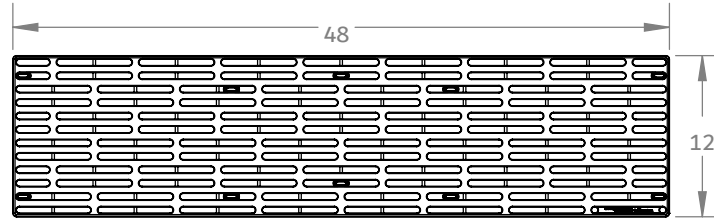

48X24 STEP PANEL

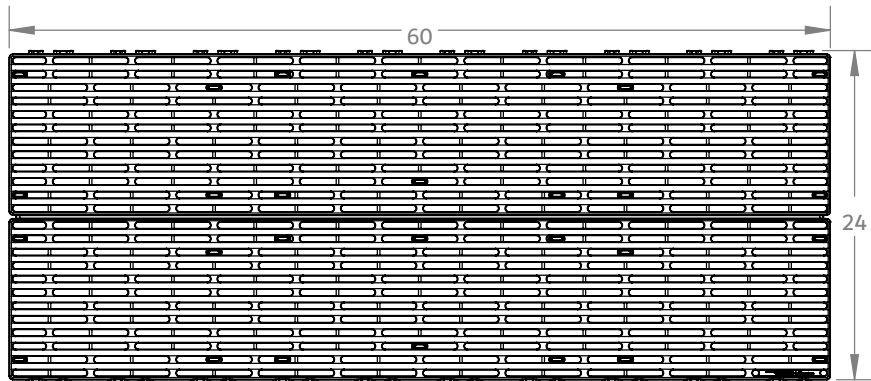

60X24 DECK PANEL

ISSUED FOR: REVIEW

DATE: 4/17/2023 **REVISION:** 2

ENGINEER: CHRIS BIENERT

NOT TO SCALE
ALL DIMENSIONS ARE IN INCHES

ALL DIMENSIONS, DESIGNS, AND INFORMATION ON THIS PRINT MUST BE CONSIDERED PROPRIETARY TO SNAP DECKING PRODUCTS AND MAY NOT BE USED, COPIED, OR DISTRIBUTED WITHOUT WRITTEN PERMISSION OF AN OFFICER (OR HIS AGENT) OF THE FIRM.

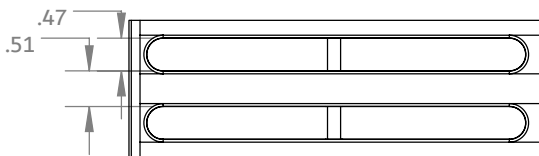
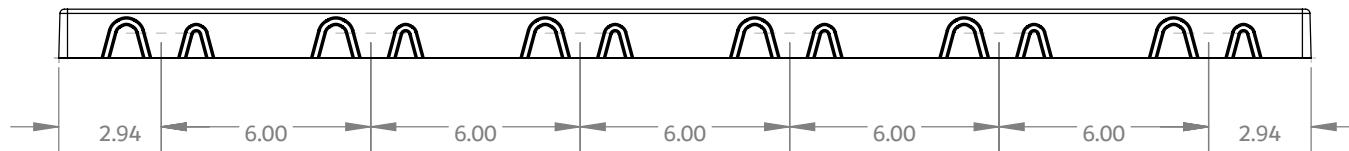
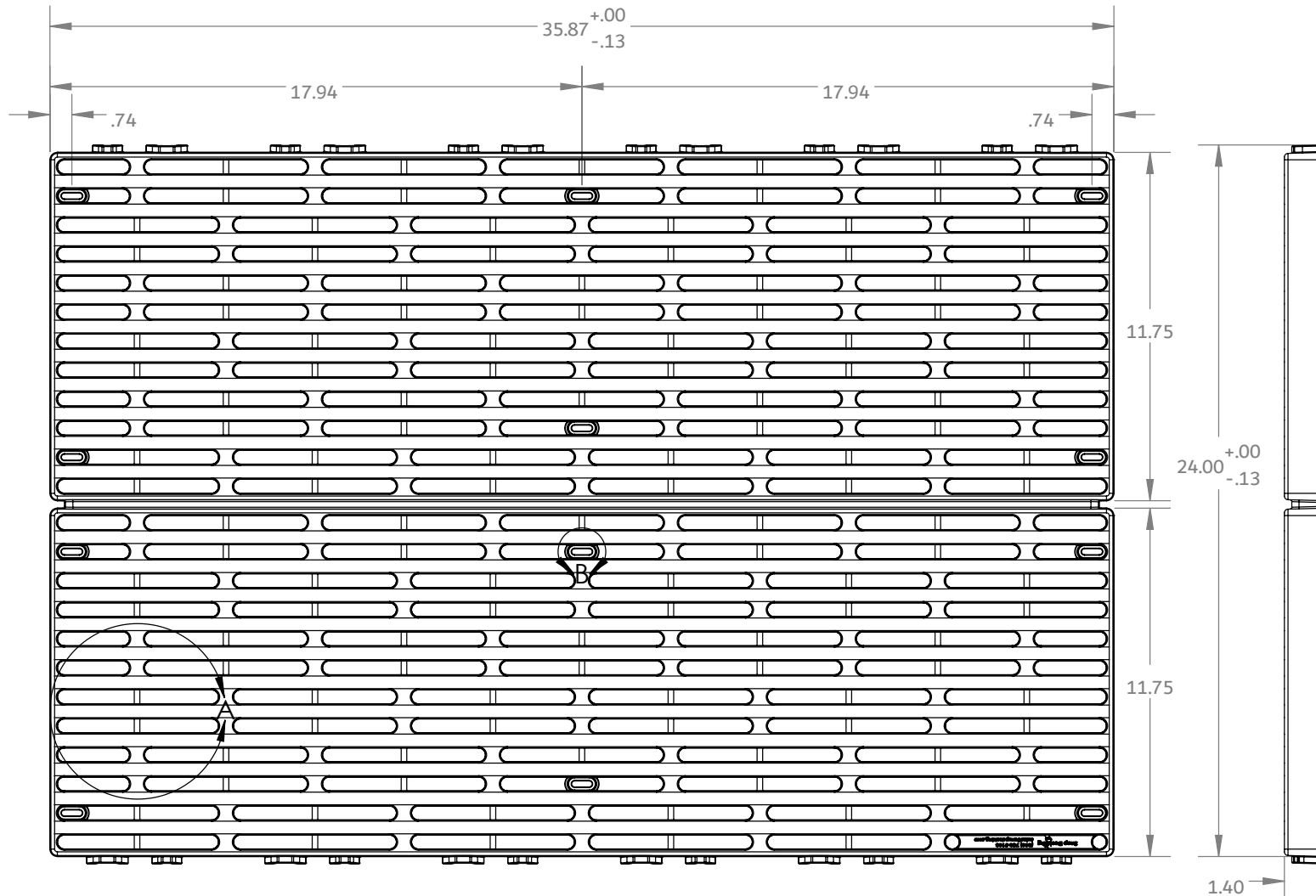

DETAIL A

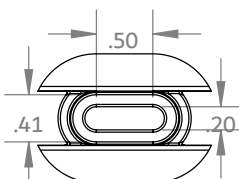

DETAIL B

- SCREW ATTACHMENT POINTS 18" OC
- FOR USE WITH #10 OR #12 PAN HEAD SCREWS
- ATTACHMENT POINTS ARE SLOTTED TO PROVIDE 1/2" OF ADJUSTMENT
- PANELS FEATURE 40% OPEN SURFACE AREA
- PANELS COMPLY WITH ADA STANDARDS FOR WALKING SURFACES
- NO GAPS LARGER THAN 0.5"
- SLIP RESISTANT SURFACE

DOCUMENT:
 SNAP DECKING PANEL
 DIMENSIONS - FINAL
TITLE:
 36"X24" PANEL DIMENSIONS

ISSUED FOR: REVIEW

DATE: 4/17/2023 **REVISION:** 2

ENGINEER: CHRIS BIENERT

NOT TO SCALE
ALL DIMENSIONS ARE IN INCHES

ALL DIMENSIONS, DESIGNS, AND INFORMATION ON THIS PRINT MUST BE CONSIDERED PROPRIETARY TO SNAP DECKING PRODUCTS AND MAY NOT BE USED, COPIED, OR DISTRIBUTED WITHOUT WRITTEN PERMISSION OF AN OFFICER (OR HIS AGENT) OF THE FIRM.

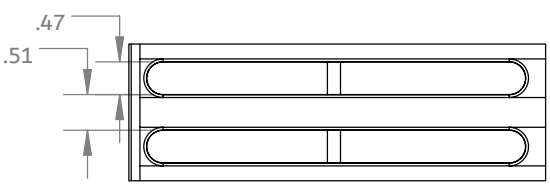
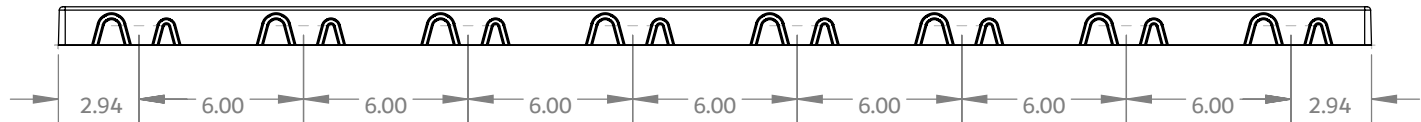
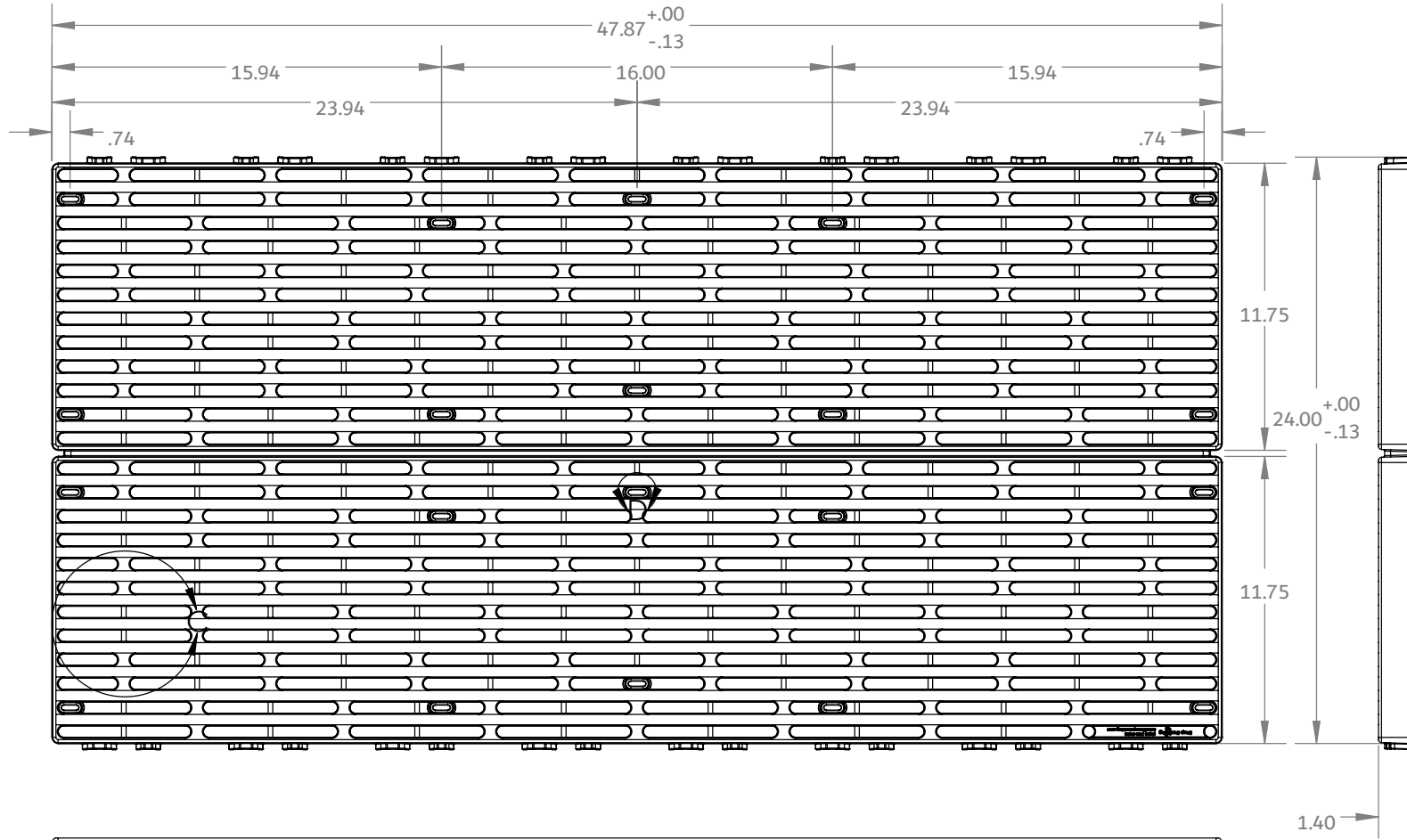

DETAIL C

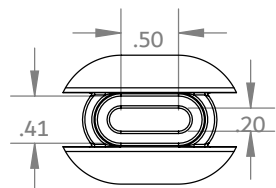

DETAIL D

- SCREW ATTACHMENT POINTS 16" OC
- FOR USE WITH #10 OR #12 PAN HEAD SCREWS
- ATTACHMENT POINTS ARE SLOTTED TO PROVIDE 1/2" OF ADJUSTMENT
- PANELS FEATURE 40% OPEN SURFACE AREA
- PANELS COMPLY WITH ADA STANDARDS FOR WALKING SURFACES
 - NO GAPS LARGER THAN 0.5"
 - SLIP RESISTANT SURFACE

DOCUMENT:
SNAP DECKING PANEL
DIMENSIONS - FINAL
TITLE:
48"X24" PANEL DIMENSIONS

ISSUED FOR: REVIEW

DATE: 4/17/2023 **REVISION:** 2

ENGINEER: CHRIS BIENERT

NOT TO SCALE
ALL DIMENSIONS ARE IN INCHES

ALL DIMENSIONS, DESIGNS, AND INFORMATION ON THIS PRINT MUST BE CONSIDERED PROPRIETARY TO SNAP DECKING PRODUCTS AND MAY NOT BE USED, COPIED, OR DISTRIBUTED WITHOUT WRITTEN PERMISSION OF AN OFFICER (OR HIS AGENT) OF THE FIRM.



DOCUMENT:
 SNAP DECKING PANEL
 DIMENSIONS - FINAL
TITLE:
 60"X24" PANEL DIMENSIONS

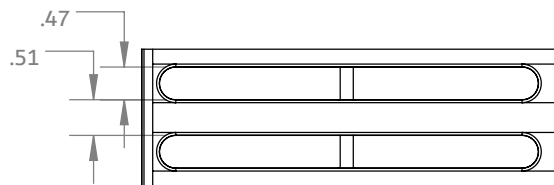
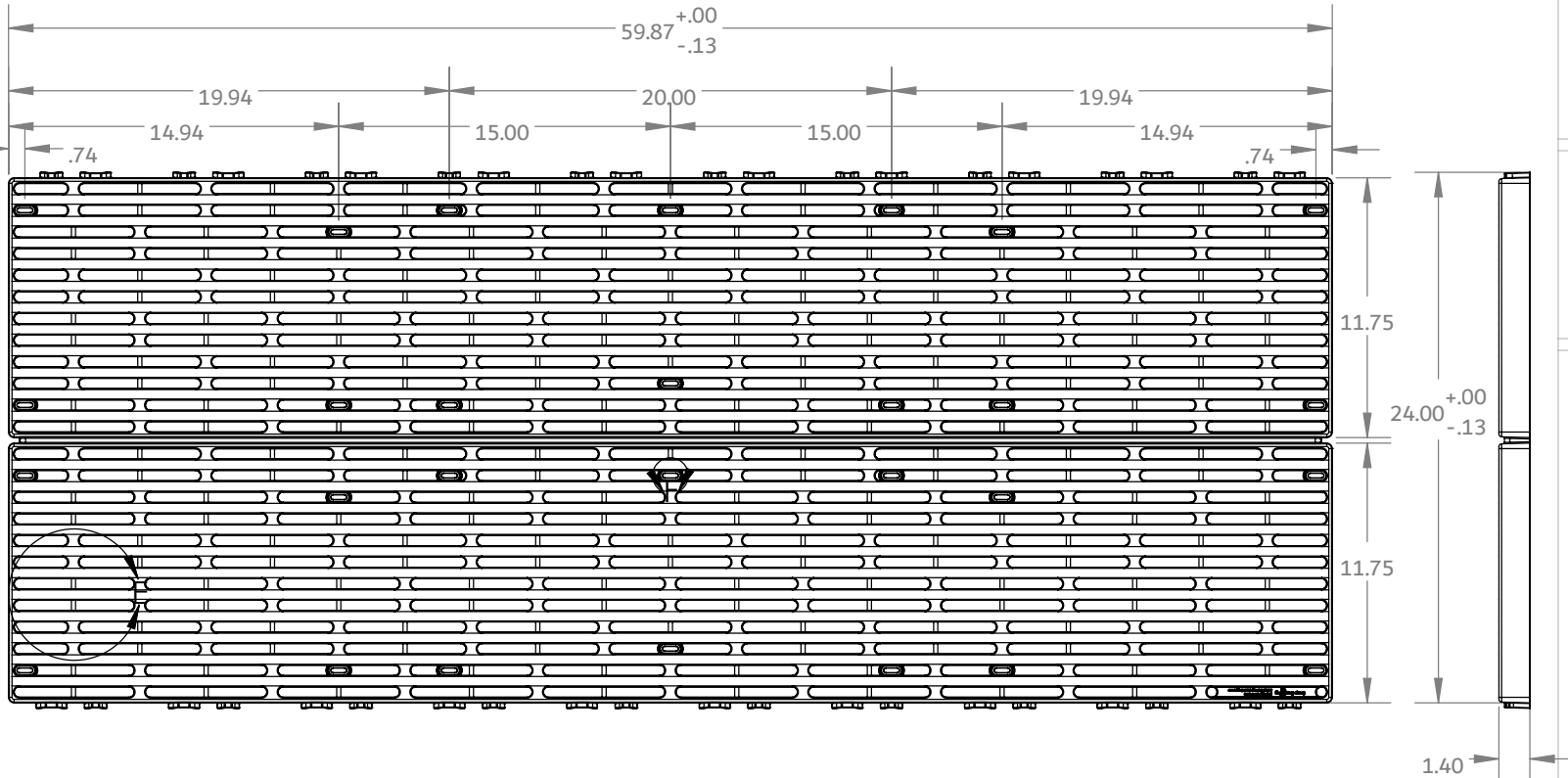

DETAIL E

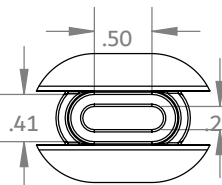

DETAIL F

- SCREW ATTACHMENT POINTS 15" OR 20" OC
- FOR USE WITH #10 OR #12 PAN HEAD SCREWS
- ATTACHMENT POINTS ARE SLOTTED TO PROVIDE 1/2" OF ADJUSTMENT
- PANELS FEATURE 40% OPEN SURFACE AREA
- PANELS COMPLY WITH ADA STANDARDS FOR WALKING SURFACES
- NO GAPS LARGER THAN 0.5"
- SLIP RESISTANT SURFACE

ISSUED FOR: REVIEW

DATE: 4/17/2023 **REVISION:** 2

ENGINEER: CHRIS BIENERT

NOT TO SCALE
ALL DIMENSIONS ARE IN INCHES

ALL DIMENSIONS, DESIGNS, AND INFORMATION ON THIS PRINT MUST BE CONSIDERED PROPRIETARY TO SNAP DECKING PRODUCTS AND MAY NOT BE USED, COPIED, OR DISTRIBUTED WITHOUT WRITTEN PERMISSION OF AN OFFICER (OR HIS AGENT) OF THE FIRM.

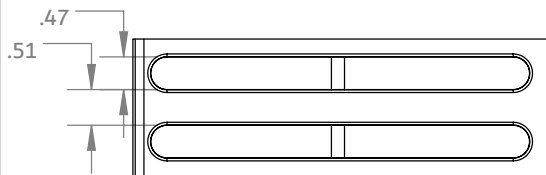
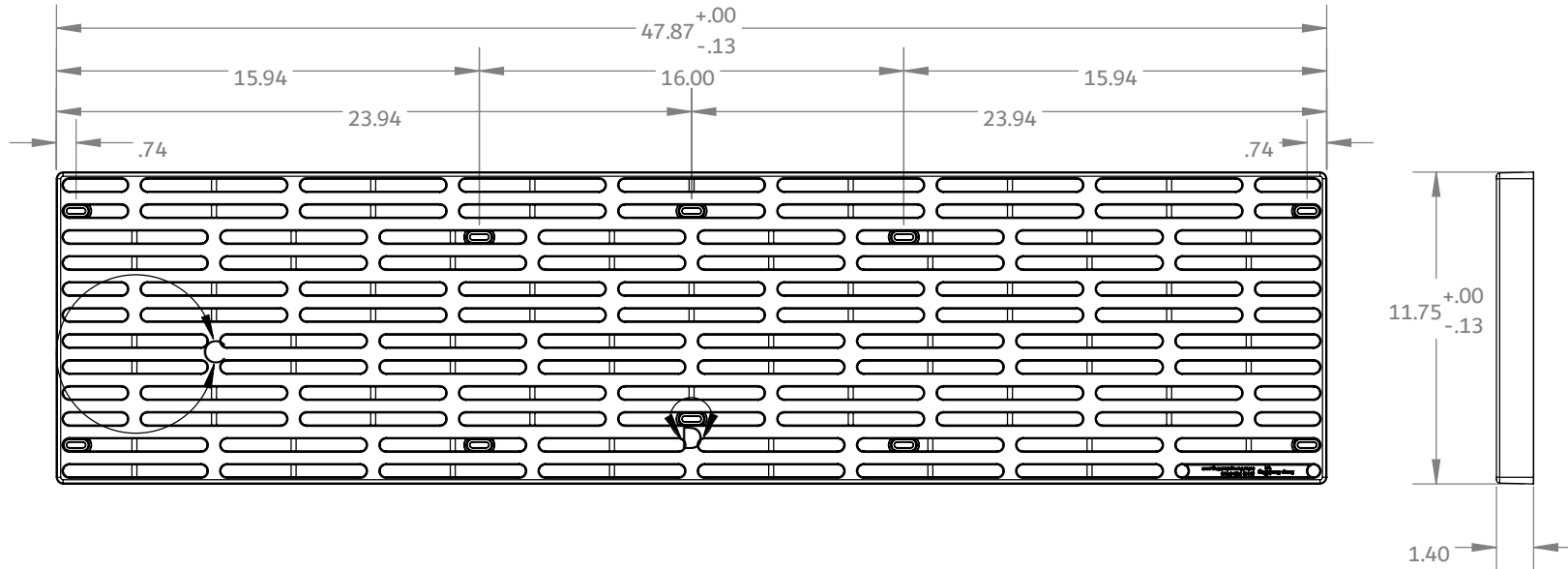

DETAIL C

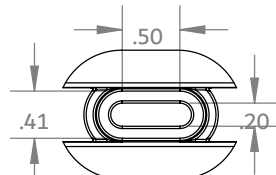

DETAIL D

- SCREW ATTACHMENT POINTS 16" OC
- FOR USE WITH #10 OR #12 PAN HEAD SCREWS
- ATTACHMENT POINTS ARE SLOTTED TO PROVIDE 1/2" OF ADJUSTMENT
- PANELS FEATURE 40% OPEN SURFACE AREA
- PANELS COMPLY WITH ADA STANDARDS FOR WALKING SURFACES
 - NO GAPS LARGER THAN 0.5"
 - SLIP RESISTANT SURFACE

DOCUMENT:
 SNAP DECKING PANEL
 DIMENSIONS - FINAL
TITLE:
 48"X12" STEP DIMENSIONS

ISSUED FOR: REVIEW

DATE: 4/17/2023 **REVISION:** 2

ENGINEER: CHRIS BIENERT

NOT TO SCALE
ALL DIMENSIONS ARE IN INCHES

ALL DIMENSIONS, DESIGNS, AND INFORMATION ON THIS PRINT MUST BE CONSIDERED PROPRIETARY TO SNAP DECKING PRODUCTS AND MAY NOT BE USED, COPIED, OR DISTRIBUTED WITHOUT WRITTEN PERMISSION OF AN OFFICER (OR HIS AGENT) OF THE FIRM.